

For Residential and Commercial Applications

Job Name:

Engineer/Architect:

Job Location:

Wholesaler:

Submittal Date:

Contractor:

SSR83X Integral Shut-Off Straight Stop w/ Lock Shield & Screwdriver Slot – Female Iron Pipe x Male Iron Pipe

Use: For use in potable water distribution systems in accessible locations only. Not intended for recirculating water systems that produce continuous use temperatures above 115° F. For those applications use our KT™ series ball stop.

Design Features:

- **Machined one-piece brass body** provides strength, durability, and long-lasting performance
- **Screwdriver slot handle** helps protect against accidental stop operation during rough-ins and in general use



Operating Specifications:

Temperature: 40° - 160° F

Pressure: 125 PSI maximum

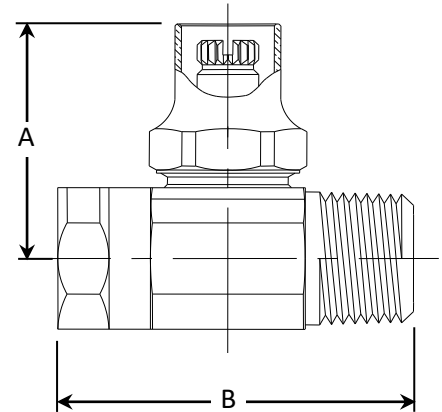

STOP MATERIAL SPECIFICATIONS

Body	Brass, plated
Screwdriver Slot Stem	Brass, plated
Bib & Packing Washers	Rubber
Packing Nut	Brass, plated

PART DIMENSIONS (Inches)

Model	DIM. A	DIM. B
SSR83	1.53	2.15

Part Listing:



SSR83X R

1/2" FIP x 1/2" MIP with lock shield & screwdriver slot, rough brass

Listings & Certifications:

- IAPMO listed to ASME A112.18.1/CSA B125.1



This specification and all information contained herein is the confidential and exclusive property of BrassCraft Manufacturing Company and shall not be disclosed to others without the written consent of BrassCraft. This specification must be returned to BrassCraft if requested.

400.74 SSR83 Integral Shut-Off w/Loose Key - FIP x MIP REV 6.21

BrassCraft®

©2021 BrassCraft Manufacturing Company