

Job Name		Engineer / Architect	
Job Location		Wholesaler	
Submittal Date		Contractor	

## 102 Series Female Iron Pipe Cross

**Use:** For use with water, grease, fuels, LP and Natural Gas, refrigeration, instrumentation, and hydraulic systems in low and medium pressure pipe line connections. Use in combination with brass, copper, and iron pipe.

**Design Features:**

- Available in a broad range of sizes

**Operating Specifications:**

- Temperature:** -65° to +250° F
- Working Pressure:** Up to 1200 PSI
- Vibration:** Fair resistance to vibration and pipe movement depending on conditions

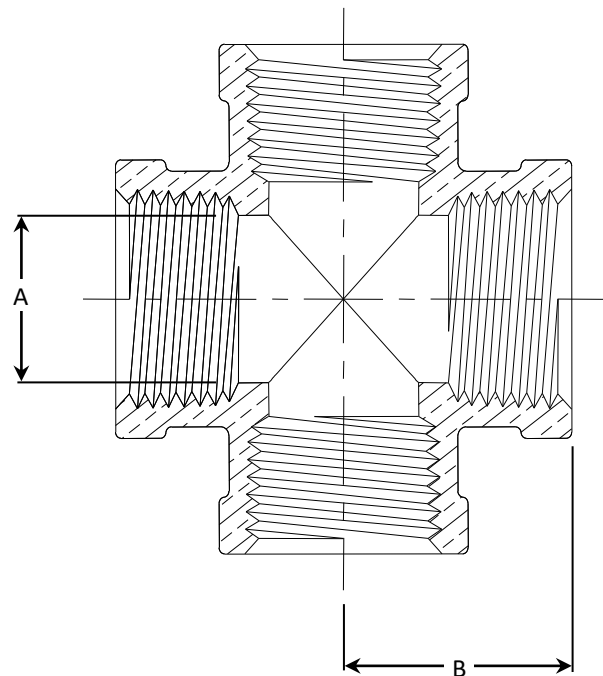
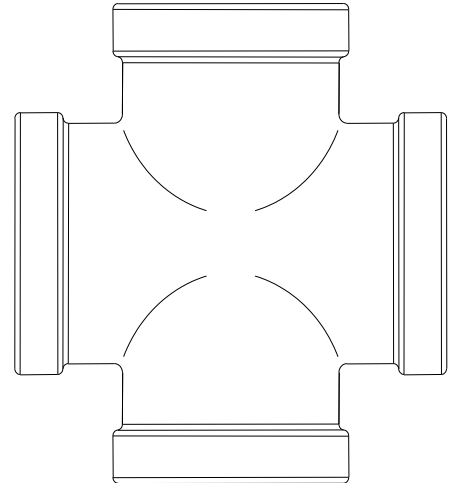

**FITTING MATERIAL SPECIFICATIONS**

<b>Body</b>	Brass
-------------	-------

**PART DIMENSIONS (Inches)**

Model	DIA. A	DIM. B
102-2	.312	.56
102-4	.406	.72
102-6	.531	.81
102-8	.688	1.00
102-12	.906	1.16

**Part Listing:**

- 102-2                    1/8" FIP, all ends
- 102-2 B                1/8" FIP, all ends, bulk
- 102-4                    1/4" FIP, all ends
- 102-4 B                1/4" FIP, all ends, bulk
- 102-6                    3/8" FIP, all ends
- 102-6 B                3/8" FIP, all ends, bulk
- 102-8                    1/2" FIP, all ends
- 102-8 B                1/2" FIP, all ends, bulk
- 102-12                 3/4" FIP, all ends